

HEAVY DUTY and VALUE HAND PALLET



KW0500398



KW0500396

Features:

- Most popular model used through out the warehouses, shops, factories, loading docks or inside truck.
- The oil pump body is made by assembling the separates prefabricated parts using threaded connection.
- All the joints are fitted with seals to ensure sealing and keep from oil leaking.
- Heavy gauge steel construction, drop forged lift link arms provide available strength and durability.
- Speed lowering valve can adjust the descent speed freely.

Nylon wheel : Low rolling resistance, hard and rigid, ideal for rough floor, resistance against debris and dirt
Polyurethane wheel : Quiet running, low vibration, better grip, ideal for good and smooth finished floor surface.

Article No.		KW0500098		KW0500398		KW0500045		KW0500399	
Description		Hand Pallet Small 3T 550 x 1150mm Nylon		Hand Pallet Small 3T 550 x 1150mm Polyurethane		Hand Pallet Big 3T 685 x 1220mm Nylon		Hand Pallet Big 3T 685 x 1220mm Polyurethane	
Specification									
Capacity (kg)						3000			
Total Lift Height	H2 (mm)					200			
Lowered Fork Height	H1 (mm)					85			
Fork Dimensions	S/E/L (mm)	53/160/1150				53/160/1220			
Width Over theFork	W (mm)	550				685			
Fork Wheel Dimensions (mm)						Ø80 x 70			
Steering Dimensions (mm)						Ø200 x 50			
Weight (kg)		63				75			
Wheel		Nylon		Polyurethane		Nylon		Polyurethane	

Article No.		KW0500288	KW0500396	KW0500289	KW0500397
Description		Hand Pallet Small 2T 550 x 1150mm Nylon	Hand Pallet Small 2T 550 x 1150mm Polyurethane	Hand Pallet Big 2T 685 x 1220mm Nylon	Hand Pallet Big 2T 685 x 1220mm Polyurethane
Specification					
Capacity (kg)		2000			
Total Lift Height	H2 (mm)	190			
Lowered Fork Height	H1 (mm)	75			
Fork Dimensions	S/E/L (mm)	53/150/1150		53/150/1220	
Width Over theFork	W (mm)	550		685	
Fork Wheel Dimensions (mm)		Ø70 x 80			
Steering Dimensions (mm)		Ø160 x 50			
Weight (kg)		55		60	
Wheel		Nylon	Polyurethane	Nylon	Polyurethane

Hand Pallet Wheel

Nylon Fork Wheel



Nylon Steering Wheel



Polyurethane Fork Wheel



Polyurethane Steering Wheel



Article No.	Description
KW0500088	Nylon Steering Wheel for KW0500045, 98, 463
KW0500089	Nylon Fork Wheel for KW0500045, 98, 463
KW0500366	Nylon Steering Wheel for KW0500288, KW0500289
KW0500367	Nylon Fork Wheel for KW0500288, KW0500289

Article No.	Description
KW0500090	Polyurethane Steering Wheel for KW0500398, 399, 500
KW0500091	Polyurethane Fork Wheel for KW0500398, 399, 500
KW0500368	Polyurethane Steering Wheel for KW0500396, 397
KW0500369	Polyurethane Fork Wheel for KW0500396, 397

LOW PROFILE HAND PALLET

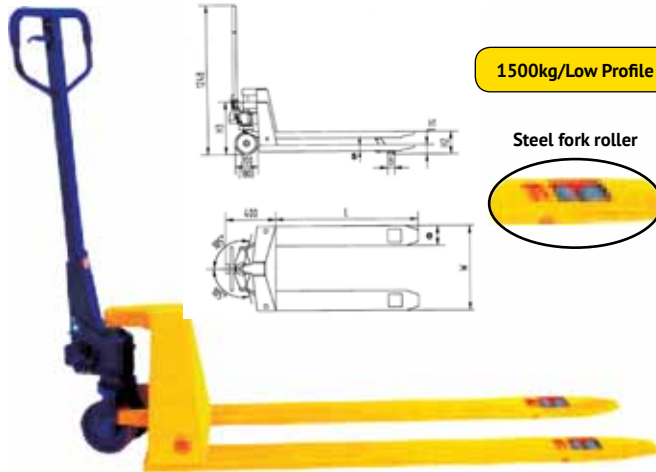

Features:

- Low-profile pallet truck
- 1500kg capacity lowered fork height - 52mm

Article No.		KW0500766
Description		Low-Profile Pallet 1.5T 685 x 1220mm
Specification		
Capacity (kg)		1500
Max Lift Height	H2 (mm)	140
Lowered Fork Height	H1 (mm)	52
Fork Dimensions	S/E/L (mm)	38/150/1220
Width Overall Fork	W (mm)	685
Fork Wheel Dimensions (mm)		Ø50 x 93
Steering Dimensions (mm)		Ø150
Ground Clearance (mm)		14
Weight (kg)		80
Wheel		Polyurethane

EXTRA LONG HAND PALLET



Features:

- Most popular model used through out the warehouses, shops, factories, loading docks or inside truck.
- The oil pump body is made by assembling the separates prefabricated parts using threaded connection. All the joints are fitted with seals to ensure sealing and keep the body from oil leaking.
- Heavy gauge steel construction, drop forged lift link arms provide available strength and durability.
- Speed lowering valve can adjust the descent speed freely.

Article No.	KW0500463	10005380
Description	Hand Pallet 1.5T 685 x 1800mm with Nylon	Hand Pallet 1.5T 685 x 1800mm with Polyurethane
Specification		
Capacity (kg)	1500	
Total Lift Height	H2 (mm)	200
Lowered Fork Height	H1 (mm)	85
Fork Length	S/E/L (mm)	53/150/1800
Width Over the Forks	W (mm)	685
Fork Wheel (mm)	Ø80 x 70	
Steering Wheel (mm)	Ø200 x 50	
Weight (kg)	147	
Wheel	Nylon	Polyurethane

STAINLESS STEEL HAND PALLET

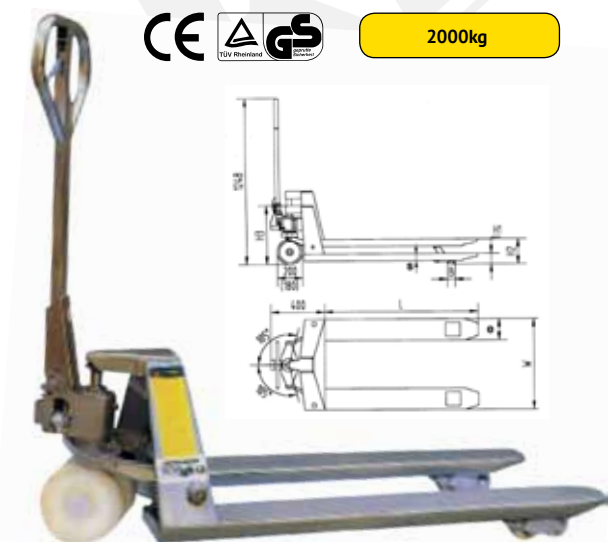

Features :

- Widely used in area of pharmacy, foods-beverages, chemical, marine
- Suitable for very low temperature condition e.g. freezer and cooler area
- Specially design for application where hygiene is of at most importance

Article No.	10016821	10016913
Model No.	SSHP-2T.550	SSHP-2T.685
Description	Stainless Steel Hand Pallet 2T, 550x1150mm	Stainless Steel Hand Pallet 2T, 685x1150mm
Specification		
Capacity (kg)	2000	
Max Lift Height	H2 (mm)	200
Lowered Fork Wheel	H1 (mm)	85
Overall Leght (mm)	1603	
Width Over Fork (mm)	W (mm)	550 685
Fork Dimension (mm)	S/E/L (mm)	45/160/1150
Turning Radius (mm)	1336	
Steering Wheel (mm)	Ø180 x 50	
Fork Wheel (mm)	Ø74 x 70	
Weight (kg)	80	
Wheel	Nylon	

* Available also for polyurethane (PU) wheel

HYDRAULIC HAND PALLET with SCALE



Display only

Optional

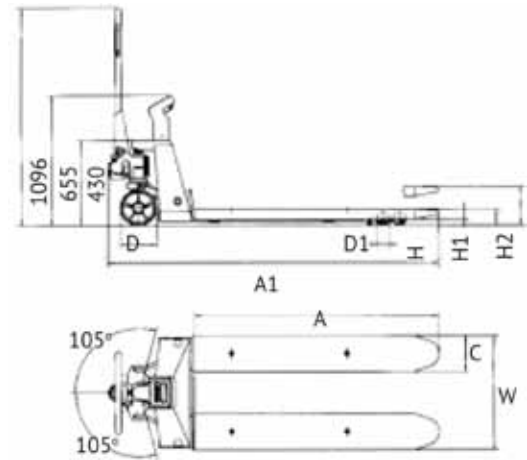
Thermal Printer Scale
10191033

This unit has been certificated by Badan Metrologi Bandung

Features :

- Capacity : 2,000kg in 1kg resolution
- Tolerance : ± 2 kg
- Scale function : zero correction, gross/nett weighing, total weight
- Power supply : 4 x 1.5V AA-batteries
- Low battery warning + auto shut off function after 3 minutes
- Total fork width 570mm, width per fork 180mm, fork length 1150mm
- Polyurethane steering wheels
- Polyurethane tandem rollers

Article No.		KW0500336
Description		Hand Pallet 2T Scale 570 x 1150mm with Polyurethane
Specification		
Capacity (kg)		2000
Min. Fork Height	H1 (mm)	85
Max. Fork Height	H2 (mm)	200
Steering Wheel (mm)		Ø180 x 50
Loader Roller (mm)		Ø74 x 70
Size of Fork	C x H (mm)	180 x 50
Width Overall Forks	W (mm)	570
Fork Length	A (mm)	1150
Overall Length (mm)		1580
Battery (v)		DC1.5 x 4 AA
Weight (kg)		90

ROUGH TERRAIN HAND PALLET



Feature:

- Robust metal frame
- Easy handling, to pull and elevate.
- Adjustable fork width
- Hydraulic elevator with built in pump
- Total turning without rotating radius.

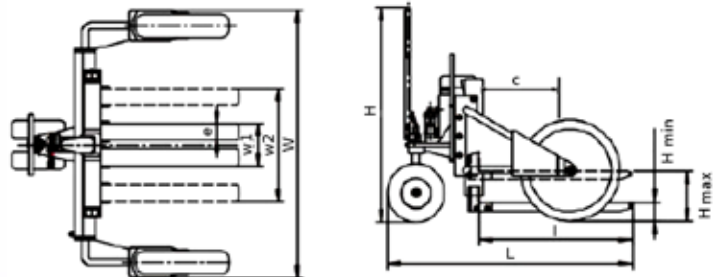

Article No.		10141909
Model No.		RTHP-1.2
Description		Rough Terrain Hand Pallet 1.2 Ton, 860x1605mm
Spesification		
Capacity (kg)	Q	1200
Fork Dimension (mm)	l/e/h	860/100/53
Load Center (mm)	c	450
Adjustable Fork Width (mm)	w1-w2	212 – 735
Max Fork Height (mm)	H max	233
Min Fork Height (mm)	H min	53
Max Pump Stroke (mm)		170
Overall Size (mm)	L/W/H	1375 x 1605 x 1200
Front Wheel (mm)	ØxW	550 x 132
Rear Wheel (mm)	ØxW	330 x 100
Wheel Type		Pneumatic Rubber
Width Inside the Front Wheel		1277
Nett Weight (kg)		235